



MM6560 SERIES ~ SMD Common Mode Choke



RoHS Compliant

FEATURES

1. Dual common-mode choke coils.
2. 8-pin, 0.8mm-pitch SMD type.
3. Low profile and small size SMD.

PART NUMBERING SYSTEM

MM	6 5 6 0	—	9 0 0	—	LF
TYPE	DIMENSIONS		IMPEDANCE		LEAD FREE

SHAPES AND DIMENSIONS

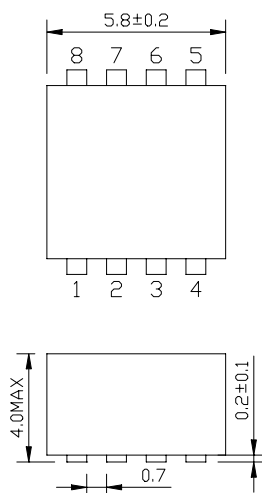

UNIT : mm

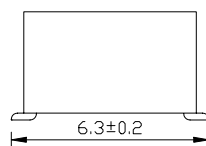

NEW Products

OLD Products

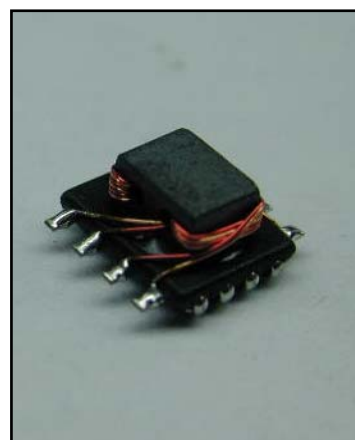
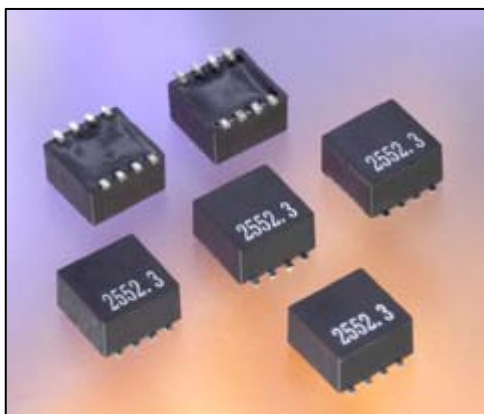



MM6560 SERIES ~ SMD Common Mode Choke



RoHS Compliant

TOP VIEW

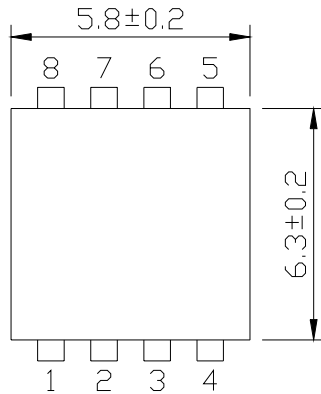

FRONT VIEW

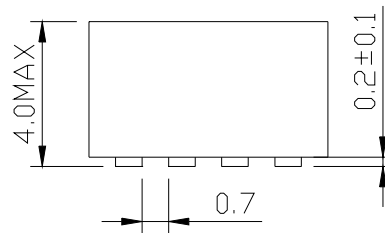

PART NUMBER	IMPEDANCE at 100MHz (Ω)	IMPEDANCE at 300MHz (Ω)	RATED CURRENT (mA)	DCR (mΩ) (Max)	RATED VOLTAGE (Vdc)	INSULATION RESISTANCE (Ω)min
MM6560-700-LF	70±25%	100 (Typ.)	500	30	100	100M
MM6560-161-LF	160±25%	220 (Typ.)	500	45	100	100M
MM6560-291-LF	290±25%	400 (Typ.)	500	60	100	100M
MM6560-451-LF	450±25%	600 (Typ.)	500	70	100	100M

- Impedance tolerance ±25%.
- Operating temperature range -40°C to +85°C .
- Electrical specifications at 25°C.
- Packing : 13" reel, machine-ready ,embossed plastic tape (1,000 parts per full reel).