



## SEP1207E SERIES ~

### High Current SMD Power Inductors



RoHS Compliant

#### PART NUMBERING SYSTEM

<u>SEP</u>	<u>1 2 0 7 E</u>	—	<u>1 R 8 M</u>	—	<u>LF</u>
TYPE	DIMENSIONS		INDUCTANCE		LEAD FREE

#### SHAPES AND DIMENSIONS :

UNIT : mm



#### FEATURES :

- \* Low profile.
- \* Magnetically shielded low DC resistance .
- \* Suitable for large current application.
- \* Laptop & Notebook computers.
- \* Battery powered equipment.
- \* DC/DC converters.
- \* Digital \ Cameras \ Scanners, CD-ROM & DVD.

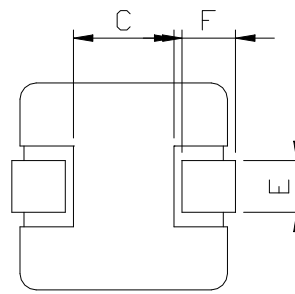
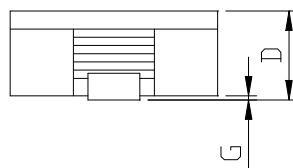
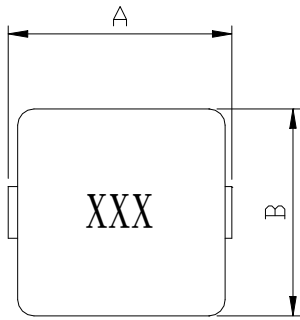

A=12.8±0.7 B=12.8±0.5 C=5.0 Ref. D=7.50 Max. E=3.3±0.5 F=1.9±0.5 G=0.2 Max. UNIT : mm

#### RECOMMENDED PATTERNS

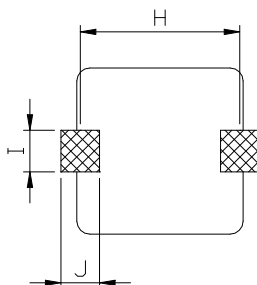

H= 10.0 I= 4.50 J= 4.50 UNIT : mm



## SEP1207E SERIES ~

### High Current SMD Power Inductors



RoHS Compliant

#### SPECIFICATION TABLE

PART NUMBER	INDUCTANCE ( $\mu\text{H}$ )	I <sub>sat</sub> ( A ) (Max.)	I <sub>rms</sub> ( A ) ( $\Delta t$ ) 40°C (Max.)	DCR (m $\Omega$ ) (Max.)	Test Freq. (KHz)
SEP1207E-R50M-LF	0.50 $\pm$ 20%	45	40	1.00	100KHz/1V
SEP1207E-1R0M-LF	1.00 $\pm$ 20%	35	30	1.50	100KHz/1V
SEP1207E-1R5M-LF	1.50 $\pm$ 20%	28	23	2.50	100KHz/1V
SEP1207E-1R8M-LF	1.80 $\pm$ 20%	23	20	2.50	100KHz/1V

- Inductance measured at 100 kHz, 0.1 Vrms .
- I<sub>sat</sub> : DC current at which the inductance drops 20% (typ) from its value without current.
- I<sub>rms</sub> : Average current for a 40°C temperature rise above 25°C ambient.
- Operating temperature range -40°C to +120°C ,
- Electrical specifications at 20°C.

#### PACKAGING SPECIFICATION

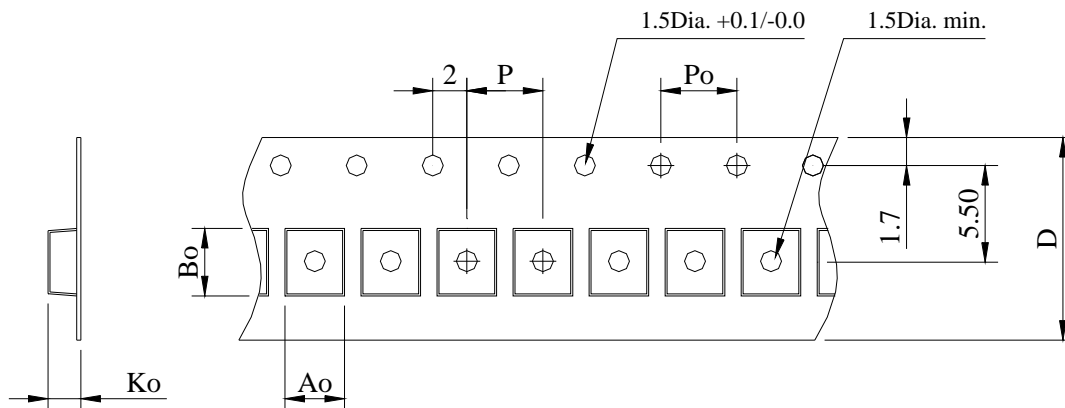

STAYLE	Q' TY (PCS)	DIMENSIONS (m/m)					
		Ao	Bo	Ko	P	Po	D $\pm$ 0.3
13"	500	14.2	13.5	7.6	20	4.0	24