



# SEP1004EA SERIES

**New Products**



## High Current SMD Power Inductors

### PART NUMBERING SYSTEM

RoHS Compliant

<u>SEP</u>	<u>1004EA</u>	—	<u>1R0M</u>	—	<u>LF</u>
TYPE	DIMENSIONS		INDUCTANCE		LEAD FREE

### SHAPES AND DIMENSIONS :



### FEATURES :

- \* Low profile.
- \* Magnetically shielded low DC resistance .
- \* Suitable for large current application.
- \* Laptop & Notebook computers.
- \* Battery powered equipment.
- \* DC/DC converters.
- \* Digital \ Cameras \ Scanners, CD-ROM & DVD.

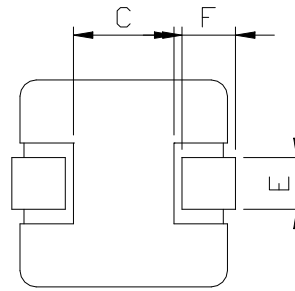
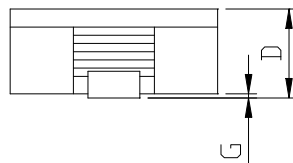
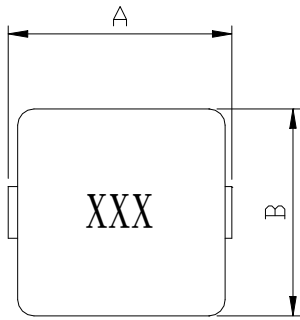

A=11.5±0.5 B=10.5±0.5 C=6.0 Ref. D=4.0 Max. E=2.5 Ref. F=2.3 Ref. G=0.2 Max. UNIT : mm

### RECOMMENDED PATTERNS

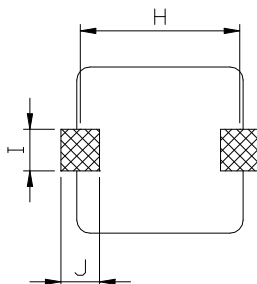

H= 9.50 I= 4.00 J= 3.50 UNIT : mm



# SEP1004EA SERIES

# New Products



## High Current SMD Power Inductors

### SPECIFICATION TABLE

RoHS Compliant

PART NUMBER	INDUCTANCE (μH)	Isat (A) (Max.)	Irms (A) (Δt) 40°C (Max.)	DCR (mΩ) (Max.)	DCR (mΩ) (Typ.)	Test Freq. (KHz)
SEP1004EA-R19M-LF	0.19±20%	60	38	0.80	0.70	100KHz/1V
SEP1004EA-R22M-LF	0.22±20%	50	38	0.80	0.60	100KHz/1V
SEP1004EA-R36M-LF	0.36±20%	50	30	1.20	1.10	100KHz/1V
SEP1004EA-R47M-LF	0.47±20%	45	28	1.70	1.50	100KHz/1V
SEP1004EA-R56M-LF	0.56±20%	40	25	1.70	1.60	100KHz/1V
SEP1004EA-R68M-LF	0.68±20%	30	25	1.80	1.60	100KHz/1V
SEP1004EA-1R0M-LF	1.00±20%	30	21	3.20	2.80	100KHz/1V
SEP1004EA-1R2M-LF	1.20±20%	25	17	3.70	3.20	100KHz/1V
SEP1004EA-1R5M-LF	1.50±20%	20	15	5.00	4.50	100KHz/1V
SEP1004EA-2R5M-LF	2.50±20%	18	13	9.50	8.50	100KHz/1V

- Isat : DC current at which the inductance drops 30% (typ) from its value without current.
- Irms : Average current for a 40°C temperature rise above 25°C ambient.
- Operating temperature range -25°C to +125°C ,
- Electrical specifications at 20°C.

### PACKAGING SPECIFICATION

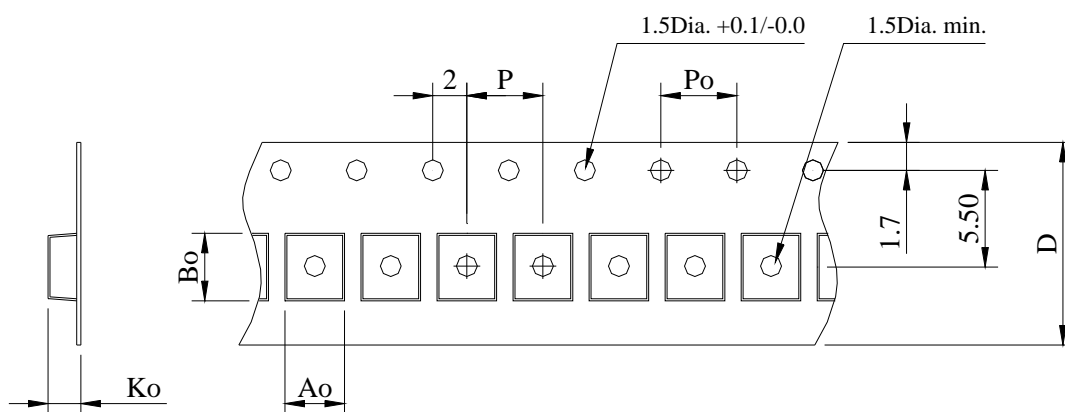

STAYLE	Q' TY (PCS)	DIMENSIONS (m/m)					
		Ao	Bo	Ko	P	Po	D±0.3
13"	800	12.2	11.2	4.1	16	4.0	24