



**SDC3D16 SERIES - Low Profile SMD Power Inductors**



**PART NUMBERING SYSTEM**

<b><u>SDC</u></b>	<b><u>3 D 1 6</u></b>	-	<b><u>1 R 5 N</u></b>	-	<b><u>LF</u></b>
TYPE	DIMENSIONS		INDUCTANCE		LEAD FREE

**SHAPES AND DIMENSIONS**

UNIT : mm

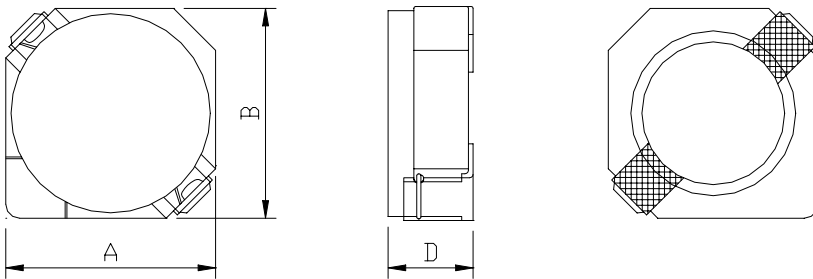

**A=4.00 max. B=4.00 max. D=1.8 max.**

**RECOMMENDED PATTERNS**

UNIT : mm

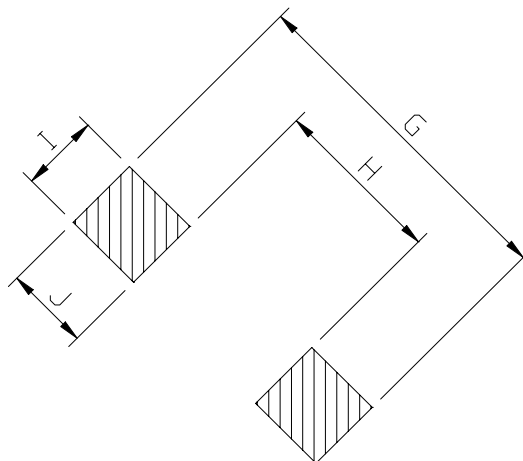

**G= 5.2 H= 2.4 I = 1.5 J = 1.4**

## SDC3D16 SERIES - Low Profile SMD Power Inductors



### SPECIFICATION TABLE

PART NUMBER	INDUCTANCE ( $\mu$ H)	DCR (m $\Omega$ ) (Max.)	Isat (A) (Max.)	Irms (A) (Max.)	TEST FREQ. (f)
SDC3D16-1R5N-LF	1.5 $\pm$ 30%	52	1.55	1.55	100KHz
SDC3D16-2R2N-LF	2.2 $\pm$ 30%	72	1.20	1.20	100KHz
SDC3D16-3R3N-LF	3.3 $\pm$ 30%	85	1.10	1.10	100KHz
SDC3D16-4R7N-LF	4.7 $\pm$ 30%	105	0.90	0.90	100KHz
SDC3D16-6R8N-LF	6.8 $\pm$ 30%	170	0.73	0.73	100KHz
SDC3D16-100N-LF	10 $\pm$ 30%	210	0.55	0.55	100KHz
SDC3D16-150N-LF	15 $\pm$ 30%	295	0.45	0.45	100KHz
SDC3D16-220N-LF	22 $\pm$ 30%	430	0.40	0.40	100KHz
SDC3D16-330N-LF	33 $\pm$ 30%	675	0.32	0.32	100KHz

Isat : DC current at which the inductance drops 35% (typ) from its value without current.  
 Irms: The actual current when temperature of coil becomes 40°C. ( Ta=+20°C )  
 Operating temperature range -40°C to +85°C , Electrical specifications at 20°C.  
 Packing : 13" reel, machine-ready ,embossed plastic tape ( 2,000 parts per full reel)..

### PACKAGING SPECIFICATION

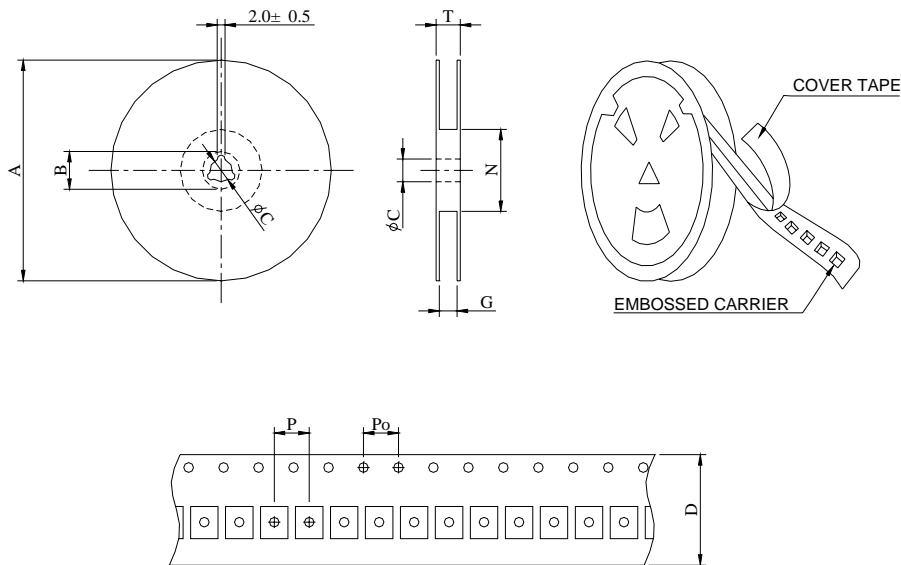

SERIES	STAYLE	Q ' TY (PCS)	DIMENSIONS (m/m)								
			A	B $\pm$ 0.8	C $\pm$ 0.5	D	G <sup>+0</sup>	N <sup>-0</sup>	P	Po	T
SDC3D16	13-16	2000	330	21	13	16	18	50	8	4	22.4