



SDS3012E SERIES ~ **New Products**



RoHS Compliant

Low Profile Shielded Power Inductors

PART NUMBERING SYSTEM

SDS	3 0 1 2 E	—	1 0 0 M	—	LF
TYPE	DIMENSIONS		INDUCTANCE		LEAD FREE

SHAPES AND DIMENSIONS

UNIT : mm

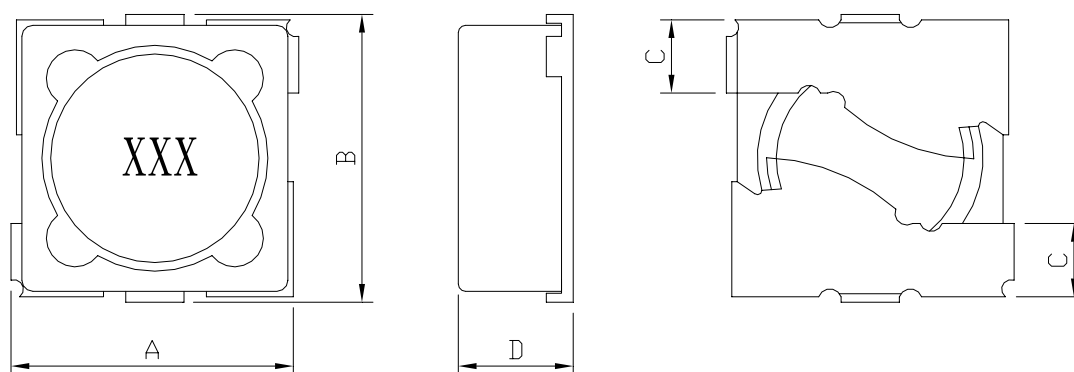

A=3.4 Max. B=3.4 Max. C=0.8 Typ. D=1.05 Max

RECOMMENDED PATTERNS

UNIT : mm

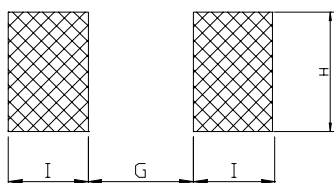

G=1.4 H=3.4 I=1.5

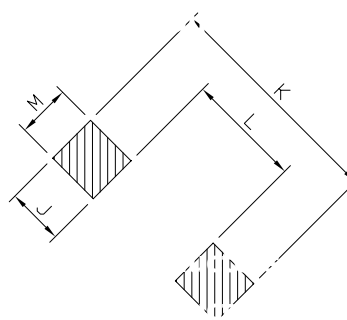

J=1.3 K=4.39 L=1.7 M=1.3

FEATURES

- Compact, Low profile shielded power inductor – only 1,05 mm high, 3.2 mm square
- Ideal for high-density applications
- Flat bottom surface ensure secure , reliable mounting .
- Handles current up to 1.4 Amps!
- RoHS-compliant. 260°C compatible.



SDS3012E SERIES ~ **New Products**



RoHS Compliant

Low Profile Shielded Power Inductors

SPECIFICATION TABLE

PART NUMBER	INDUCTANCE (μ H)	DCR (Ω) (Max.)	Isat (A)	Irms (A) @ 25°C Rise	TEST FREQ. (f)
SDS3012E-1R2M-LF	1.2 \pm 20%	0.094	1.40	1.50	1KHz/1V
SDS3012E-1R5M-LF	1.5 \pm 20%	0.105	1.36	1.40	1KHz/1V
SDS3012E-1R8M-LF	1.8 \pm 20%	0.117	1.24	1.35	1KHz/1V
SDS3012E-2R2M-LF	2.2 \pm 20%	0.127	1.08	1.25	1KHz/1V
SDS3012E-3R3M-LF	3.3 \pm 20%	0.216	0.88	1.00	1KHz/1V
SDS3012E-4R7M-LF	4.7 \pm 20%	0.336	0.82	0.85	1KHz/1V
SDS3012E-6R8M-LF	6.8 \pm 20%	0.450	0.60	0.70	1KHz/1V
SDS3012E-100M-LF	10 \pm 20%	0.603	0.54	0.60	1KHz/1V
SDS3012E-150M-LF	15 \pm 20%	0.960	0.40	0.50	1KHz/1V
SDS3012E-220M-LF	22 \pm 20%	1.320	0.32	0.40	1KHz/1V
SDS3012E-330M-LF	33 \pm 20%	1.920	0.28	0.34	1KHz/1V

- Inductance tested at 100 kHz, 0.1 Vrms, 0 Adc using an Agilent/HP 4263B LCR meter or equivalent.
- Isat : DC current at which the inductance drops 30% (typ) from its value without current.
- Irms: Current that causes the specified temperature rise from 25°C ambient.
- Electrical specifications at 25°C.
- Packing Qty 2,000pcs with 7' reel (178mm)