



SPO1604 SERIES ~

Low Profile Power Inductors



RoHS Compliant

PART NUMBERING SYSTEM

SPO	1604	1R0M	LF
TYPE	DIMENSIONS	INDUCTANCE	LEAD FREE

SHAPES AND DIMENSIONS

UNIT : mm

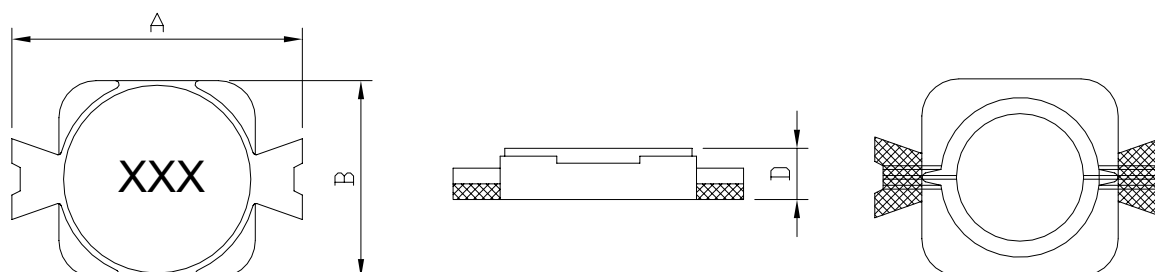

A= 7.3 Max. B= 5.5 Max. D= 1.2 Max.

PCB LAYOUT

UNIT : mm

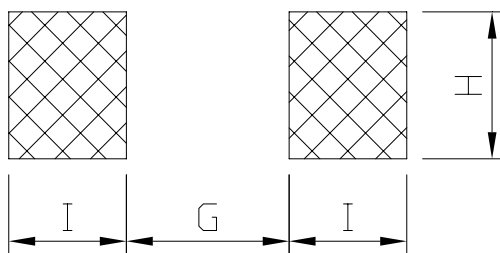

A= 7.3 Max. B= 5.5 Max. D= 1.2 Max.



SPO1604 SERIES ~

Low Profile Power Inductors



RoHS Compliant

SPECIFICATION TABLE

PART NUMBER	INDUCTANCE (μ H)	DCR (m Ω) (Max.)	IDC (A) (Typ.)	TEST FREQ. (Hz)
SPO1604-1R0M-LF	1.0	55	3.00	1V/100K
SPO1604-1R5M-LF	1.5	65	2.60	1V/100K
SPO1604-2R2M-LF	2.2	100	2.10	1V/100K
SPO1604-3R3M-LF	3.3	180	1.70	1V/100K
SPO1604-4R7M-LF	4.7	300	1.30	1V/100K
SPO1604-6R8M-LF	6.8	370	1.15	1V/100K
SPO1604-100M-LF	10.0	570	1.00	1V/100K
SPO1604-150M-LF	15.0	720	0.85	1V/100K
SPO1604-220M-LF	22.0	1000	0.65	1V/100K
SPO1604-330M-LF	33.0	1900	0.55	1V/100K

1. Inductors tolerance M= \pm 20%.
2. Temp. rise 40 $^{\circ}$ C Max. at IDC.
3. DC current at which the inductance drops 10%(typ) from its value without current.
4. Operating temperature : -25 $^{\circ}$ C ---- +85 $^{\circ}$ C.
5. Storage temperature : -40 $^{\circ}$ C ---- +125 $^{\circ}$ C.