



Coilmaster Electronics Co., Ltd.

9F-3 No.398, Huan Bei Rd. Chung Li City, Taoyuan 320, Taiwan
Tel : +886-3-422-8279 Fax : +886-3-422-8734

E-mail : info@coilmaster.com.tw
Web Site : www.coilmaster.com.tw

SSB3010DS SERIES

Low Profile Power Inductors



RoHS Compliant

PART NUMBERING SYSTEM

<u>SSB</u>	<u>3010DS</u>	—	<u>3 3 1 M</u>	—	<u>LF</u>
TYPE	DIMENSIONS		INDUCTANCE		LEAD FREE

SHAPES AND DIMENSIONS

UNIT : mm

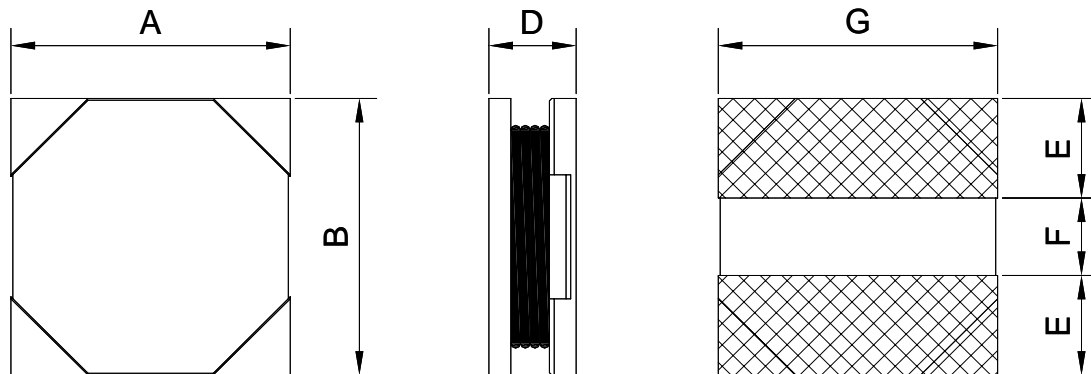

A=3.2 Max. B=3.2 Max. D=1.0 Max. E=1.0 Typ. F=0.95 Typ. D=2.93 Typ.

RECOMMENDED PATTERNS

UNIT : mm

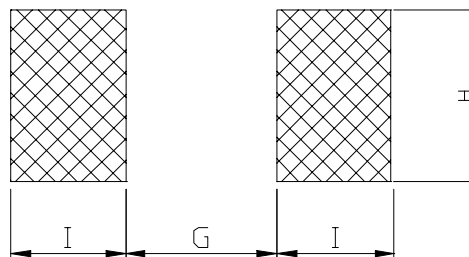

G=0.8 H=3.1 I=1.25

FEATURES

- Compact, Low profile shielded power inductor – only 1,0 mm high, 3 mm square
- Ideal for high-density applications
- Inductance range from *0.47uH to 330uH*
- Handles current up to 2.3 Amps!
- RoHS-compliant. 260°C compatible.



SSB3010DS SERIES

Low Profile Shielded Power Inductors



RoHS Compliant

ELECTRICAL CHARACTERISTICS :

PART NUMBER	INDUCTANCE (μ H)	DCR (Ω) (Max.)	I _{rms} (A) (Max.)	I _{sat} (A) (Max.)	SRF typ. (HZ)
SS3010DS-R47M-LF	0.47 \pm 20%	0.070	1.80	2.30	370
SSB3010DS-R68M-LF	0.68 \pm 20%	0.080	1.50	1.80	270
SSB3010DS-1R0M-LF	1.0 \pm 20%	0.085	1.30	1.60	230
SSB3010DS-1R5M-LF	1.5 \pm 20%	0.120	1.20	1.30	165
SSB3010DS-1R8M-LF	1.8 \pm 20%	0.150	1.00	1.20	150
SSB3010DS-2R2M-LF	2.2 \pm 20%	0.220	0.90	1.09	130
SSB3010DS-3R3M-LF	3.3 \pm 20%	0.220	0.85	0.82	110
SSB3010DS-4R7M-LF	4.7 \pm 20%	0.300	0.70	0.72	92
SSB3010DS-5R6M-LF	5.6 \pm 20%	0.400	0.60	0.66	80
SSB3010DS-6R8M-LF	6.8 \pm 20%	0.450	0.56	0.62	70
SSB3010DS-8R2M-LF	8.2 \pm 20%	0.500	0.53	0.55	62
SSB3010DS-100M-LF	10 \pm 20%	0.540	0.48	0.51	58
SSB3010DS-120M-LF	12 \pm 20%	0.700	0.44	0.45	47
SSB3010DS-150M-LF	15 \pm 20%	0.950	0.38	0.40	43
SSB3010DS-180M-LF	18 \pm 20%	1.00	0.33	0.37	40
SSB3010DS-220M-LF	22 \pm 20%	1.20	0.30	0.33	36
SSB3010DS-330M-LF	33 \pm 20%	2.00	0.26	0.27	27
SSB3010DS-470M-LF	47 \pm 20%	3.20	0.22	0.24	21
SSB3010DS-680M-LF	68 \pm 20%	3.50	0.20	0.20	21
SSB3010DS-101M-LF	100 \pm 20%	5.25	0.18	0.16	14
SSB3010DS-121M-LF	120 \pm 20%	6.10	0.15	0.13	12
SSB3010DS-151M-LF	150 \pm 20%	9.15	0.13	0.13	11
SSB3010DS-181M-LF	180 \pm 20%	10.1	0.11	0.11	9
SSB3010DS-221M-LF	220 \pm 20%	12.5	0.095	0.11	8
SSB3010DS-331M-LF	330 \pm 20%	18.5	0.085	0.10	7

- Inductance tested at 100 kHz, 0.1 Vrms, 0 Adc using an Agilent/HP 4263B LCR meter or equivalent.
- I_{sat}: For inductance values \geq 10 μ H, DC current at which the inductance drops 20% (max) from its value without current. For inductance values $<$ 10 μ H, DC current at which the inductance drops 30% (max) from its value without current.
- Operating temperature range -40 $^{\circ}$ C to +85 $^{\circ}$ C , Electrical specifications at 20 $^{\circ}$ C .