



## SDB1108 SERIES - SMD Power Inductors



### PART NUMBERING SYSTEM

<b>SDB</b>	<b>1 1 0 8</b>	-	<b>3 3 0 M</b>	-	<b>LF</b>
TYPE	DIMENSIONS		INDUCTANCE		LEAD FREE

### SHAPES AND DIMENSIONS

UNIT : mm

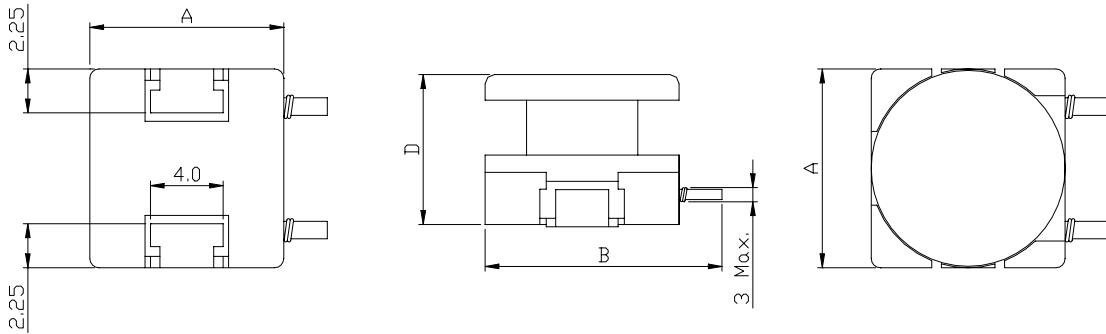

**A=11.60 Max. B=14.00 Max. D=8.50 Max.**

### RECOMMENDED PATTERNS

UNIT : mm

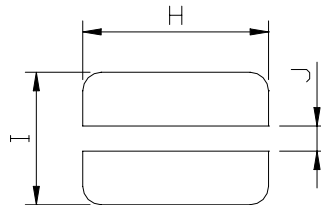

**H=5.08 ref. I=12.95 ref. J=5.08 ref.**

### FEATURES

- Available for lead free and RoHS compliant
- Suitable for large current .
- Ideal for a variety of DC-DC converter inductor applications .



## SDB1108 SERIES - SMD Power Inductors



### SPECIFICATION TABLE

PART NUMBER	INDUCTANCE ( $\mu$ H)	DCR ( ) (Max.)	IDC ( A ) (Max.)	TEST FREQ. ( f )
SDB1108-100M-LF	10 $\pm$ 20%	0.06	3.50	1 KHz
SDB1108-120M-LF	12 $\pm$ 20%	0.07	3.40	1 KHz
SDB1108-150M-LF	15 $\pm$ 20%	0.08	3.10	1 KHz
SDB1108-180M-LF	18 $\pm$ 20%	0.09	3.00	1 KHz
SDB1108-220M-LF	22 $\pm$ 20%	0.10	2.60	1 KHz
SDB1108-270M-LF	27 $\pm$ 20%	0.11	2.40	1 KHz
SDB1108-330M-LF	33 $\pm$ 20%	0.12	2.30	1 KHz
SDB1108-390M-LF	39 $\pm$ 20%	0.14	2.10	1 KHz
SDB1108-470M-LF	47 $\pm$ 20%	0.17	1.95	1 KHz
SDB1108-560M-LF	56 $\pm$ 20%	0.19	1.85	1 KHz
SDB1108-680M-LF	68 $\pm$ 20%	0.22	1.65	1 KHz
SDB1108-820M-LF	82 $\pm$ 20%	0.25	1.50	1 KHz
SDB1108-101M-LF	100 $\pm$ 20%	0.35	1.40	1 KHz
SDB1108-121M-LF	120 $\pm$ 20%	0.40	1.30	1 KHz
SDB1108-151M-LF	150 $\pm$ 20%	0.47	1.20	1 KHz
SDB1108-181M-LF	180 $\pm$ 20%	0.63	1.00	1 KHz
SDB1108-221M-LF	220 $\pm$ 20%	0.73	0.95	1 KHz
SDB1108-271M-LF	270 $\pm$ 20%	0.97	0.90	1 KHz
SDB1108-331M-LF	330 $\pm$ 20%	1.15	0.80	1 KHz
SDB1108-391M-LF	390 $\pm$ 20%	1.30	0.75	1 KHz
SDB1108-471M-LF	470 $\pm$ 20%	1.48	0.65	1 KHz
SDB1108-561M-LF	560 $\pm$ 20%	1.90	0.60	1 KHz
SDB1108-681M-LF	680 $\pm$ 20%	2.45	0.50	1 KHz
SDB1108-821M-LF	820 $\pm$ 20%	2.55	0.48	1 KHz
SDB1108-102M-LF	1000 $\pm$ 20%	3.00	0.46	1 KHz
SDB1108-122M-LF	1200 $\pm$ 20%	3.50	0.35	1 KHz

DC current at which the inductance drops 10% (typ) from its value without current.

Operating temperature range -40°C to +85°C

Electrical specifications at 25°C.



## SDB1108 SERIES - SMD Power Inductors

### PACKAGING SPECIFICATION

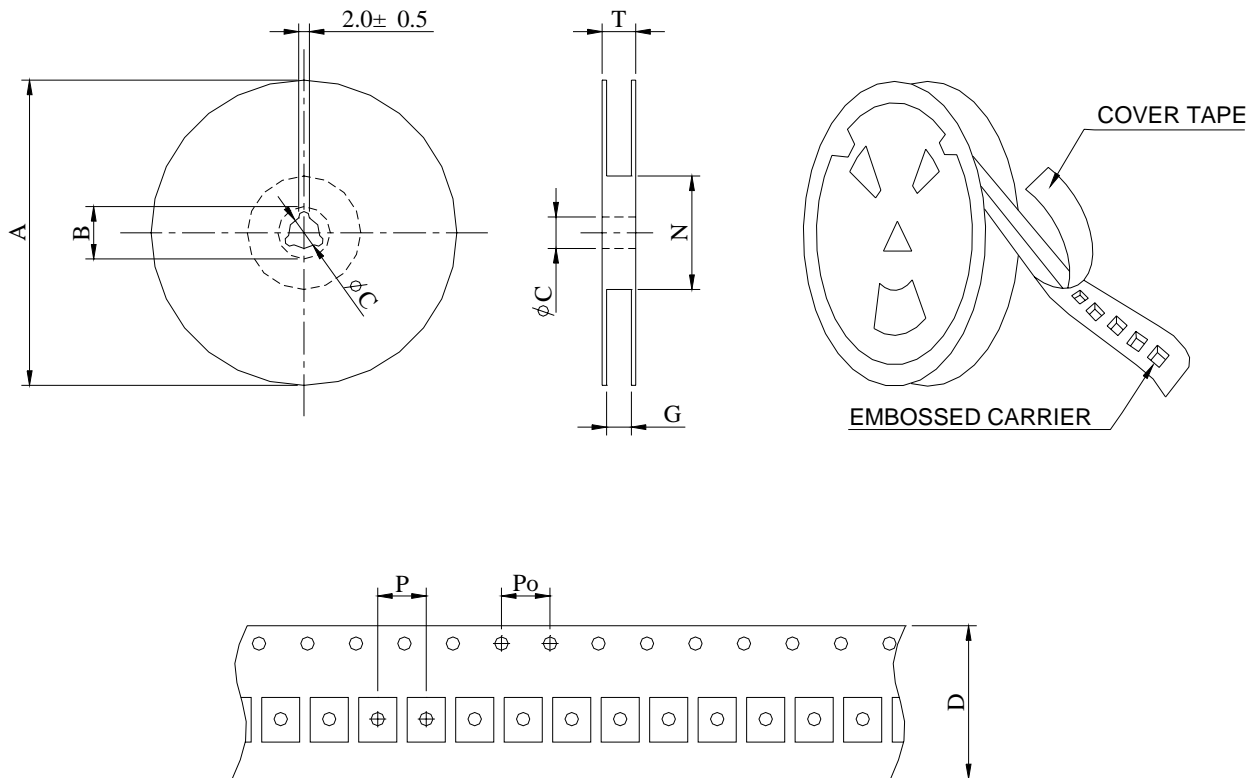

SERIES	Q ' TY (PCS)	DIMENSIONS (m/m)							
		A	B	C $\pm$ 0.5	D $\pm$ 0.5	G $\pm$ 0.3	N $\pm$ 2	P	Po
SDB1108	250	330	100	13.5	24	24.5	75	20	4